

# SDW-F

IMADA-SS UNIVERSAL TESTING MACHINE

Tensile compression testing machine from 2kN to 200kN for gate type frame. There are floor standing type and desktop type.

\* Please contact us for the Universal testing machine with 200kN specifications.

\* Design, appearance and specifications may be changed for modifications or improvements without any prior notice.

Manufacturer



91-1 Hashira 6 bancho, Toyohashi,  
Aichi Japan, 441-8058  
PHONE.+81 532 45 8851  
FAX. +81 532 46 6231  
E-mail: info@imada-ss.co.jp  
<http://www.imada-ss.co.jp>

Agency



GALA NO.122, KEYTUO INDUSTRIAL ESTATE,  
KONDIVITA VILLAGE ROAD,  
M.I.D.C, ANDHERI (EAST)  
MUMBAI : 400059  
Phone: 022-49711705 / 022-49711719.  
Mobile: +91-9892404060 / +91-9004104401  
Website: [www.shraddhaimpex.net](http://www.shraddhaimpex.net)

CAT-SDW-F\_2202E

# IMADA-SS UNIVERSAL TESTING MACHINE

# SDW-F

Model “SDW-F” is the Universal testing machine that can measure from 2kN to 200kN. This is the gate type frame testing machine that puts a load on the test piece. There are two types, the desktop type that can be used on the work table and the floor-standing type.

## Characteristics

- This is a gate type frame structure that allows you to test relatively large test pieces.
- It can be also used for the test of the small load by adding a smaller load-range.

## Usage example

- Various material tests of the middle load.
- Tests of relatively large samples are possible with this gate type frame structure.



Model SDW-010F

Touch type operation panel

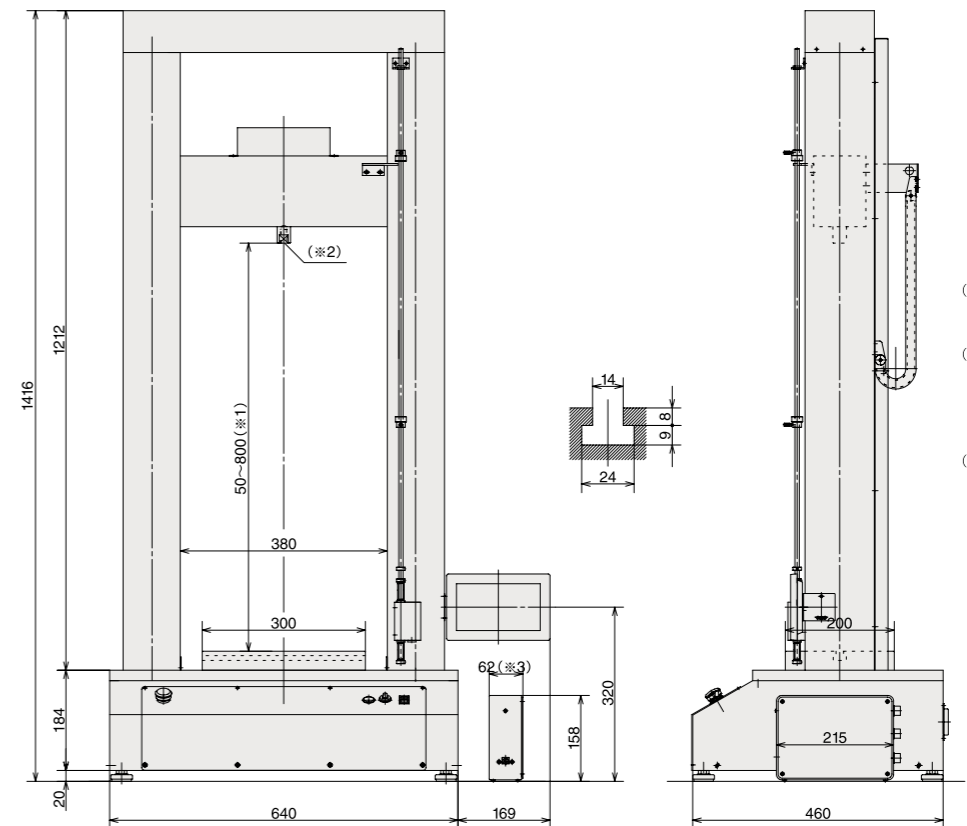

Model SDW-010F/020F

- (※1) The maximum stroke 800mm is in the state where the jig is not attached.
- (※2) Loadcell screw size  
Model SDW-010: M12P1.75 depth 25mm  
Model SDW-020: M16P1.5 depth 25mm
- (※3) For options and custom orders, Model SL-6003 measurement amplifier is "Type B" with the width of 88mm.

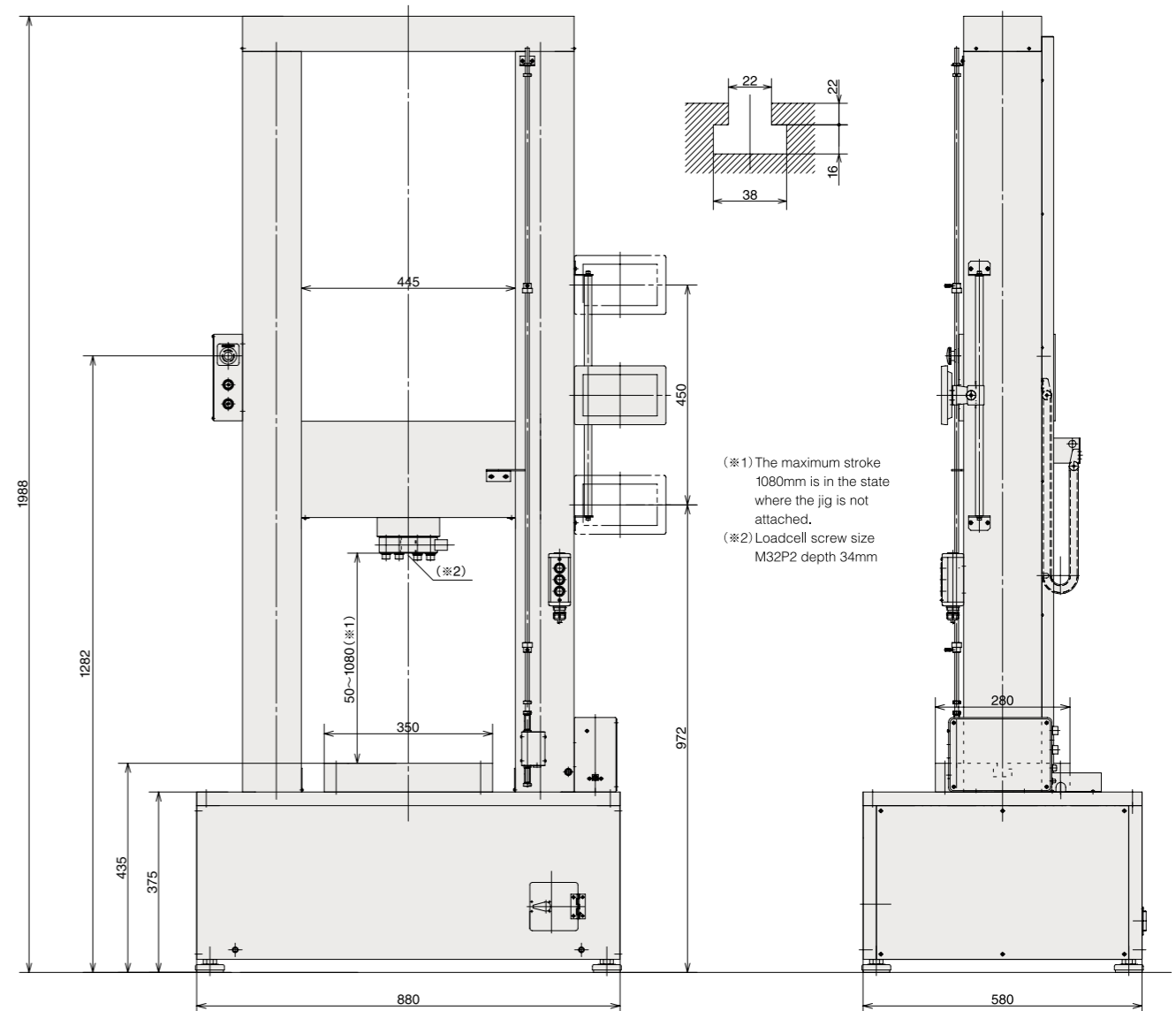

Model SDW-100F

- (※1) The maximum stroke 1080mm is in the state where the jig is not attached.
- (※2) Loadcell screw size M32P2 depth 34mm

Custom order specifications

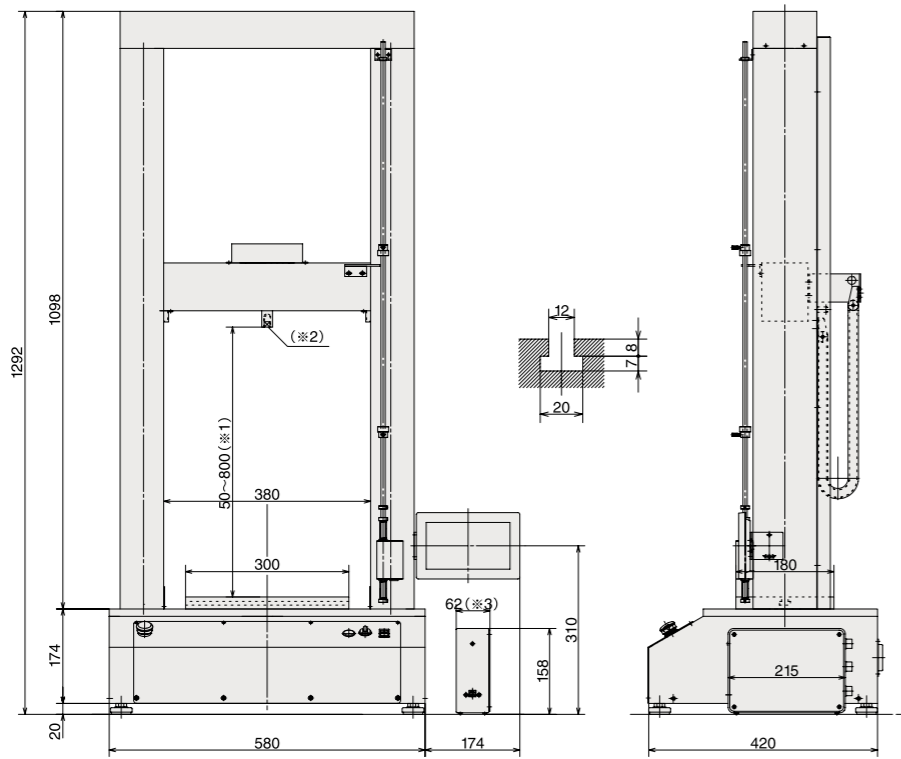

Model SDW-002F/005F

- (※1) The maximum stroke 800mm is in the state where the jig is not attached.
- (※2) Loadcell screw size M12P1.75 depth 20mm
- (※3) For options and custom orders, Model SL-6003 measurement amplifier is 'Type B' with the width of 88mm.



Model SDW-100F

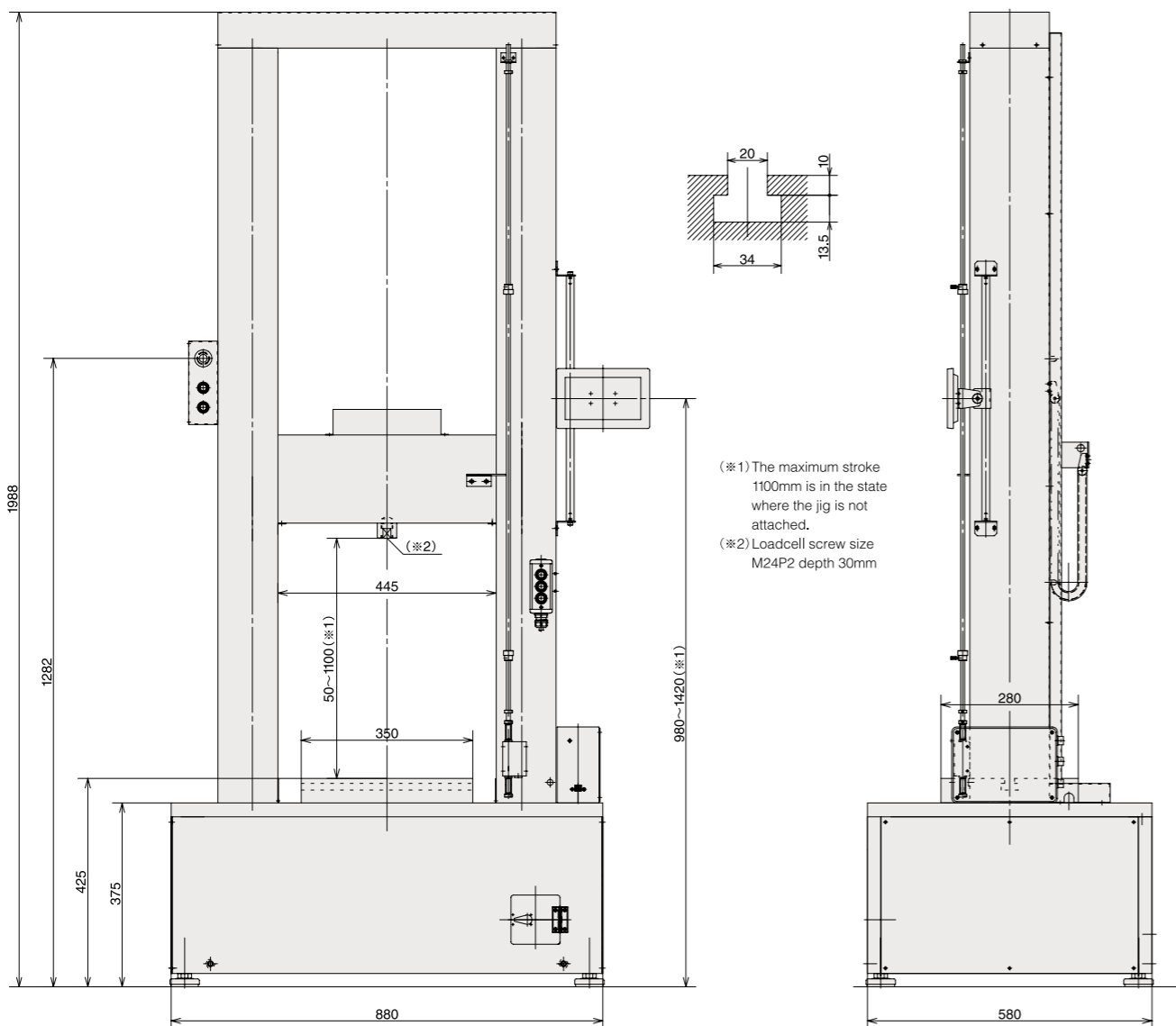

Model SDW-050F

- (※1) The maximum stroke 1100mm is in the state where the jig is not attached.
- (※2) Loadcell screw size M24P2 depth 30mm

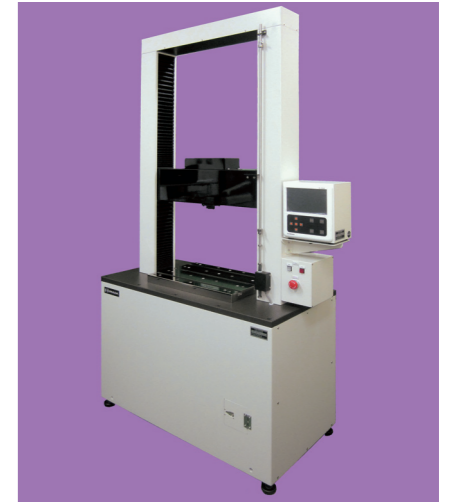

Desk type



The wide type of effective test width



Constant-Temperature Chamber furnished



200kN Range type

## Standard specifications

Model (※1)	SDW-002F-□	SDW-005F-□	SDW-010F-□	SDW-020F-□	SDW-050F-□	SDW-100F-□
Maximum load	2kN	5kN	10kN	20kN	50kN	100kN
Minimum Unit	[Combination of Load Range according to the model] / [Specifications of Load Range] Reference					
Load Display	JIS 1 class (Indication value ±1% range)					
Load Precision	0.01mm					
Displacement Minimum Unit	AC Servo Motor					
Drive type	1000mm/min					
Maximum speed (※2)	1000mm/min		500mm/min		1000mm/min	
Test speed range	0.05~500mm/min		0.1~300mm/min		0.05~500mm/min	
Distance of Sample to Column (※3)	Max. 800mm			Max. 1100mm		Max. 1080mm
Effective Test Width	380mm			445mm		
Table Size	300×180mm (With T-groove)		300×200mm (With T-groove)		350×280mm (With T-groove)	
Salty Device	Optional setting Upper and Lower Limit					
Basic Function	Over-load Prevention function					
	Memory function of the test conditions					
	Peak Hold function					
	Cycle mode function					
	Detect function of Break Point					
	Detect function of Start Point					
	Auto Feed function					
	Auto Start Point Return function					
	Judgment function					
	Output (※4)	USB				
Installation type	Desktop type			Floor-standing type		
Power supply	AC100V 10A			AC200V 30A 3 phase		
Weight	Approx. 102kg		Approx. 156kg		Approx. 440kg	
Size	W580×D422×H1292mm		W640×D460×H1416mm		W880×D580×H1988mm	

(※1) The model symbol is put in □. Refer to [Combination of Load Range according to the mode].

(※2) Maximum speed can be used for return and manual operation. And at the time of the test, it will be used within the test speed range.

(※3) An effective stroke is decided by selection of an attachments.

(※4) Analog output and Printer output can be installed with option.

## Combination of Load Range according to the model

Model	Usable Range	Setting Load Range										
		100kN	50kN	20kN	10kN	5kN	2kN	1kN	500N	200N	100N	
SDW-002F-R1	400N ~ 2kN	-	-	-	-	-	●	-	-	-	-	
SDW-002F-R2	100N ~ 2kN	-	-	-	-	-	●	-	●	-	-	
SDW-002F-R3	20N ~ 2kN	-	-	-	-	-	●	-	●	-	●	
SDW-005F-R1	1kN ~ 5kN	-	-	-	-	●	-	-	-	-	-	
SDW-005F-R2	200N ~ 5kN	-	-	-	-	●	-	●	-	-	-	
SDW-005F-R3	40N ~ 5kN	-	-	-	-	●	-	●	-	●	-	
SDW-010F-R1	2kN ~ 10kN	-	-	-	●	-	-	-	-	-	-	
SDW-010F-R2	400N ~ 10kN	-	-	-	●	-	●	-	-	-	-	
SDW-010F-R3	100N ~ 10kN	-	-	-	●	-	●	-	●	-	-	
SDW-020F-R1	4kN ~ 20kN	-	-	●	-	-	-	-	-	-	-	
SDW-020F-R2	1kN ~ 20kN	-	-	●	-	●	-	-	-	-	-	
SDW-020F-R3	200N ~ 20kN	-	-	●	-	●	-	●	-	-	-	
SDW-050F-R1	10kN ~ 50kN	-	●	-	-	-	-	-	-	-	-	
SDW-050F-R2	2kN ~ 50kN	-	●	-	●	-	-	-	-	-	-	
SDW-050F-R3	400N ~ 50kN	-	●	-	●	-	●	-	-	-	-	
SDW-100F-R1	20kN ~ 100kN	●	-	-	-	-	-	-	-	-	-	
SDW-100F-R2	4kN ~ 100kN	●	-	●	-	-	-	-	-	-	-	
SDW-100F-R3	1kN ~ 100kN	●	-	●	-	●	-	-	-	-	-	

## Specifications of Load Range

Load Range	Maximum Load Display	Minimum Unit
100kN	100.00kN	0.01kN
50kN	50.00kN	
20kN	20.00kN	
10kN	10.000kN	0.001kN
5kN	5000N	1N
2kN	2000N	
1kN	1000.0N	
500N	500.0N	0.1N
200N	200.0N	
100N	100.00N	0.01N

※The usable range is recommended at 20~100% of each setting Load Range.

※It is possible as an option to add Load Range other than the above listed.

## Accessories / Option

### Digital printer DP-1VA (Option)

※To use this, it is necessary to install the 'Printer output'.



Mitutoyo	
DP-1VA LOGGER	
* MODE 1 *	
DATE	2021/12/ 1
TIME	8:24
* LOG =	0
* LOG STOP *	
1	8.3 N
2	31.0 N
3	25.4 N
4	42.3 N

Model	DP-1VA
Printing style	Thermal line dot
Communication	Digimatic output terminal
Paper	No.09EAA082(58X)
Power supply	AC100V (DC Adapter)
Weight	Approx. 390g
Size	W94×D201×H75mm
Accessories	DC Adapter/Paper 1role/Cable C-201

### Protection cover (Option)

The whole of the moving part is covered. When a window is not closed, there is the safety device which cannot perform movement of the testing machine.



### Transformer (Option)

The power supply for SDW-002F to 020F is AC100V. The transformer is required when using these overseas.

※Please contact us for overseas use of SDW-050F/100F type.



Model	Input	Output	Max. current	weight
CD120-10S	115~120V	100V	10A	2.7kg
CD220-10S2	220V			6.6kg
CD240-10S2	230~240V			

### Extensometer Model GTD-50 (Option)

It is clipped to test piece such as metal or plastic, in order to measure amount of elongation precisely. The elongation is displayed by switching on the displacement display.

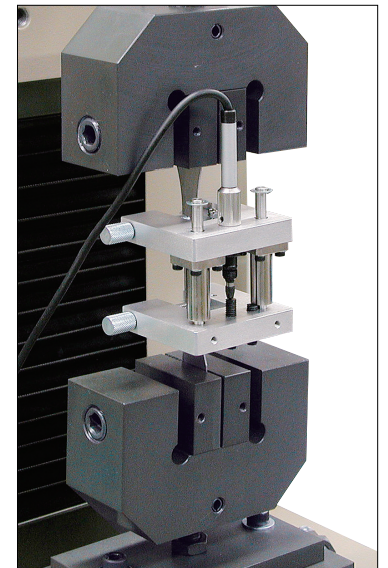

Model	GTD-50
Gauge mark	50mm
Max. elongation	10mm
Resolution	0.001mm
Max. sample size	Plate 13mm Pipe ø15mm
weight	Approx. 400g

### Extensometer Model GTD-1000 (Option)

This is a type use in case of large elongation as rubber. It is produced by quantity of stroke the testing machine type.

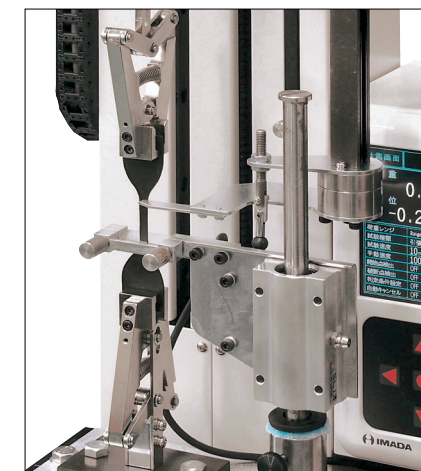

- The addition of the load range.
- Displacement resolution 1μm specifications.
- Output of ANALOG  
Option to output load and displacement values at 10V/FS for connection to analog equipment.
- Software