

Attachments for MTS series

Attachments for IMADA torque stand MTS series
Various attachments are available to suit your samples

<MTS attachment selections usable for samples of different sizes, shapes and materials>



Standard Chuck



Small Chuck



Pin Chuck



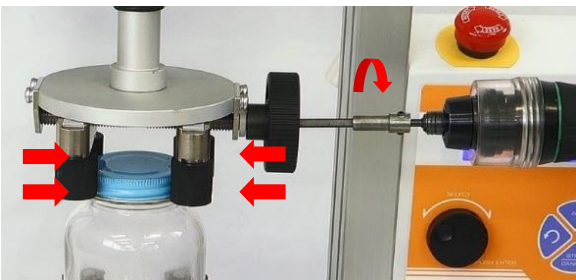

M10 Adapter

Standard Chuck

Standard Chuck Standard Pin MT-TB	
	<p>Suitable for clamping samples such as bottle caps.</p> <ul style="list-style-type: none"> • Standard Chuck Capacity: 5N-m Allowable Sample Diameter: $\phi 20$ to 90mm Weight: Approx.0.7kg Material: Steel • Standard Pin Pin weight: Approx.22g/pcs Pin material: Aluminum and Urethan
	<p>Enables high repeatability torque measurement by constantly fastening with torque measuring instrument.</p>

[Pins and Spare Rubbers] Pins and Spare Rubbers are available for replacement.

Standard Pin MT-TB-P	Long Shaft Pin MT-TB-03P	Spare Rubber MT-TB-RB
		
<p>Suitable for clamping samples such as bottle caps</p> <p>Pin weight: Approx.22g/pcs Pin material: Aluminum and Urethan</p>	<p>Suitable for holding nozzle caps, etc. since its long shaft allows the pin knob to avoid obstacles and to clump the sample properly.</p> <p>Pin weight: Approx.48g/pcs Pin material: Steel, Aluminum, and Urethan</p>	<p>Spare replacement rubber for MT-TB Pins.</p> <p>Compatible model: MT-TB-P / MT-TB-03P</p>

* For the purchase of Standard Chuck with Long Shaft Pins, please contact us.

* Pins and Spare rubbers are sold in set of 4.

[Dimensions]

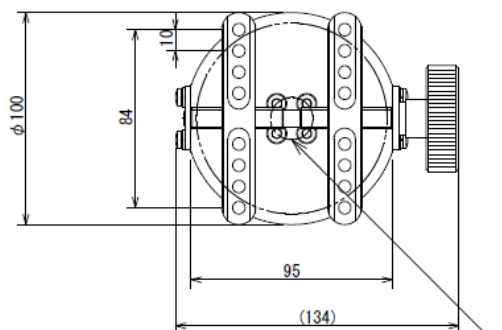

Allowable sample diameter φ20~φ90

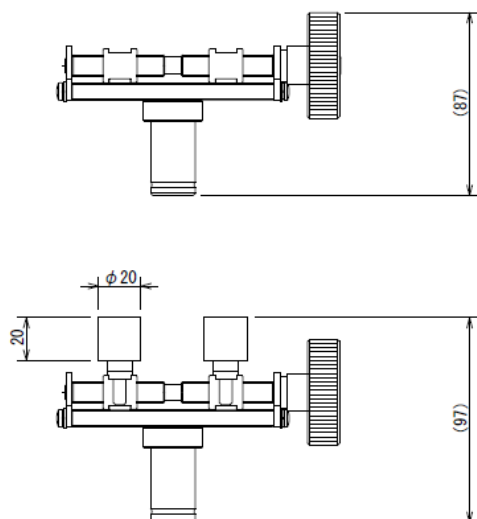
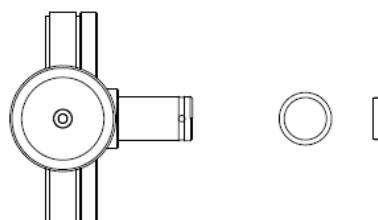

The dimension at mounting the pins

Pins

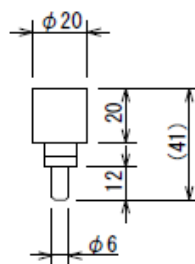

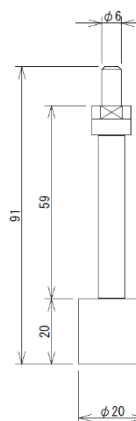

MT-TB-P



MT-TB-03P



Unit: mm

Small Chuck (For 2/5N-m range)

Small Chuck Standard Pin MT-ST	Small Chuck Notch Pin MT-ST-01	Small Chuck Long Clamp Pin MT-ST-02
		
Suitable for measuring small samples such as eye drop lids.	Suitable for firmly fixing samples such as connectors made of resin.	Suitable for clamping samples such as nozzle caps.
<ul style="list-style-type: none"> • Small Chuck Capacity: 5N-m Allowable Sample Diameter: φ7 to 50mm Weight: Approx.270g Material: Steel and Urethan • Standard Pin Pin weight: Approx.3g/pcs Pin material: Aluminum and Urethan 	<ul style="list-style-type: none"> • Small Chuck Capacity: 5N-m Allowable Sample Diameter: φ7 to 50mm Weight: Approx.270g Material: Steel and Urethan • Standard Pin Pin weight: Approx.10g/pcs Pin material: Stainless-steel 	<ul style="list-style-type: none"> • Small Chuck Capacity: 5N-m Allowable Sample Diameter: φ7 to 50mm Weight: Approx.270g Material: Steel and Urethan • Standard Pin Pin weight: Approx.8g/pcs Pin material: Aluminum and Urethan

* Small chuck and pins cannot be used for 0.5N-m range.

[Pins] Pins are available for replacement.

Standard Pin ST-P	Notch Pin ST-01P	Long Clamp Pin ST-02P
		
Suitable for measuring small samples such as eye drop lids.	Suitable for firmly fixing samples such as connectors made of resin.	Suitable for clamping samples such as nozzle caps.

* Pins and Spare rubbers are sold in set of 4.

[Dimensions]

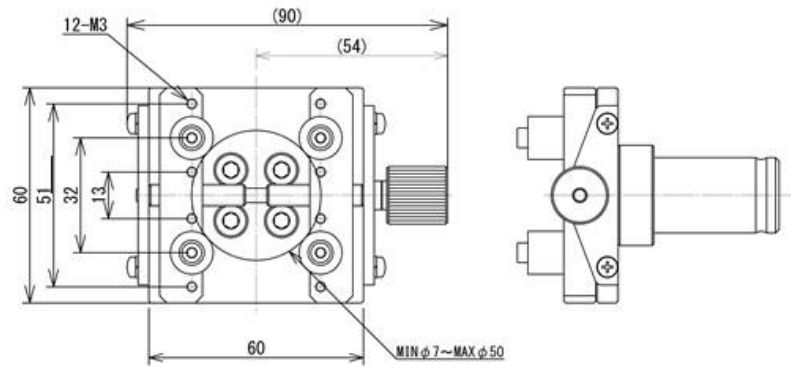

Pins

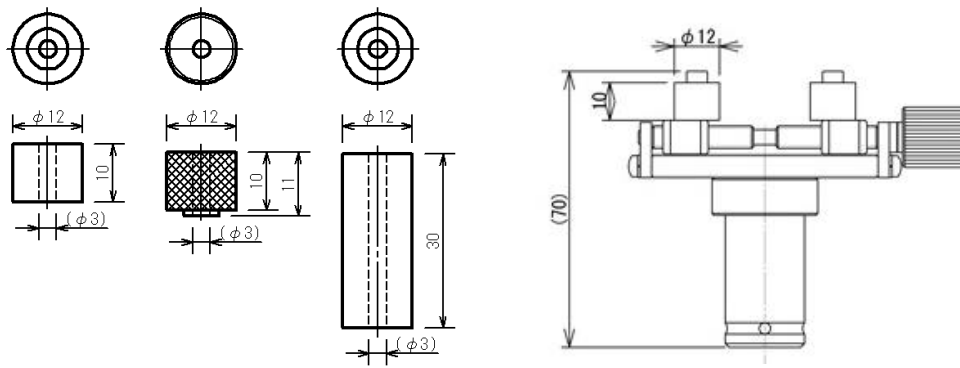

Unit: mm

Pin Chuck

	Feature
	The three claws clamp samples such as wire and round-bar samples.

[Specifications]

Model	MT-DC-4	MT-DC-6.5	MT-DC-6.5SUS	MT-DC-13
Maximum torque	5N-m	10N-m	10N-m	10N-m
Opening width	φ0.5~4mm	φ0.5~6.5mm	φ0.5~6.5mm	φ1.2~13mm
Weight	Approx.170g	Approx.270g	Approx.270g	Approx.650g
Material	Steel	Steel	Stainless-steel (*)	Steel

* We recommend using the stainless-steel chuck under the circumstance making metal rust.

[Dimensions]

MT-DC-4

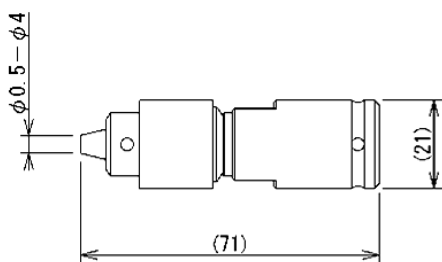

MT-DC-6.5/ MT-DC-6.5SUS

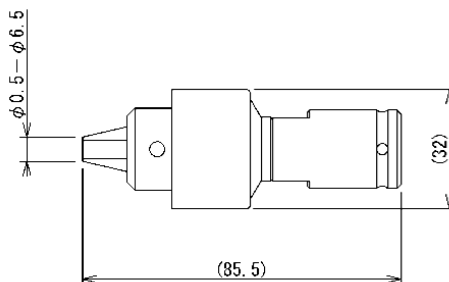

MT-DC-13

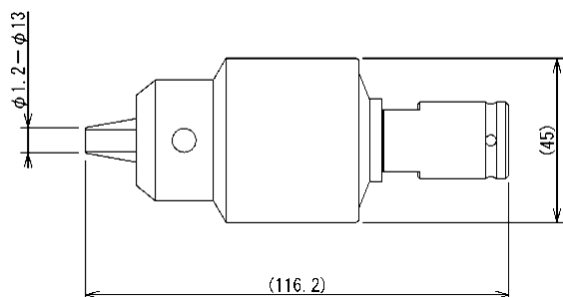

Unit: mm

M10 adapter

	Feature
	<p>The adapter for mounting an original jig by the customers. The customers can use their own jig to measure torque.</p>

[Specifications]

Model	MT-AD-M10
Screw	M10×L20
Weight	Approx.50g

[Dimensions]

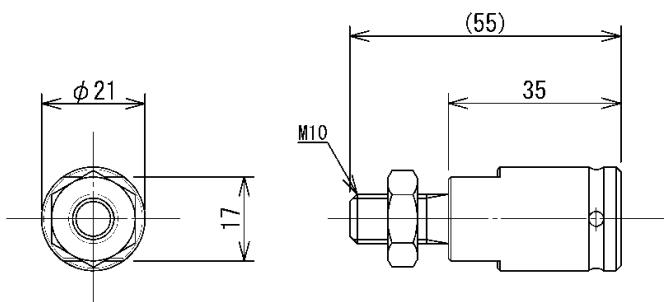

Unit: mm

[Cautions]

- Information in this document is subject to change without prior notice.
- This document is product descriptions and handling precautions, and do not guarantee various characteristics or safety.
- This product is designed for force measurement purpose only.
- Do not copy and use this content without authorization.
- Some samples may not be suitable to measure with this product.

SHRADDHA IMPEX
 Authorized Distributor

Email: shraddhaimpex@gmail.com / sales@shraddhaimpex.net
 Web: www.shraddhaimpex.net
 Contact: +918356968200/ +919819530352/ +918591279918