

HAND
MANUALES

Z-SERIES

TITANIUM
DE TITANIO

ACCESSORIES
ACCESORIOS

SCREWDRIVERS
DESTORNILLADORES

IMPACT
DE IMPACTO

SLEEVE-DRIVE

INDUSTRIAL
INDUSTRIALES

PROTECTOR
PROTECTORES

AUTOMOTIVE

CONSTRUCTION
CONSTRUCCIÓN

2749RK



2752RK 2752N



2753RK 2753N, 2753PS, 2753P, 2753P-160, 2753J, 2774PS, 2774JS, 2774N, 2774P, 2774J



2753BRK 2753NB, 2753PB, 2753JB



2725RK 2725Z, 2726Z



2749RK-3/8 2749PS-3/8, 2749N-3/8, 2749P-3/8, 2774PS-3/8, 2774JS-3/8



3749RK 3749S, 3749N



3749BRK 3749SB



3752RK 3752N, 3752J, 3757, 3776N, 3776P, 3776J



3753RK 3753SM, 3753N, 3753P, 3753P-250, 3753J, 3774PS, 3774P-SR, D3753J, 3774N, 3774P, 3774J, 3774NL, 3774PL, 3774JL



3753BRK 3753SMB, 3753NB, 3753PB, 3753JB, 3774NB, 3774PB, 3774JB, 3774JL



3725RK 3725Z, 3725ZS, 3726Z, 3726ZS



168T-6IP(40) TORXPlus® 6IP Screwdriver for 2725RK

168T-8IP(40) TORXPlus® 8IP Screwdriver for 3725RK



	▣	⚖ (g)	📦 (pce.)	
2749RK	1/4"	30	1	
2752RK		42	1	
2753RK		30	1	
2753BRK		31	1	
2725RK		30	1	
2749RK-3/8	3/8"	45	1	
3749RK		70	1	
3749BRK		84	1	
3752RK		84	1	
3753RK		76	1	
3753BRK		77	1	
3725RK		50	1	
168T-6IP(40)		—	20	1
168T-8IP(40)		—	20	1

3749SRK-1/2 3749S-1/2



3749SBRK-1/2 3749SB-1/2



4749RK 4749N-250
4749N-380, 4749J-380



4750RK 4750N, 4750P, 4750J



4750BRK 4750NB, 4750PB, 4750JB

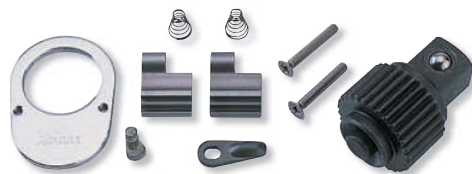

4752RK 4752N, 4752J



4753RK 4753N, 4753P, 4753P-410, 4753J, D4753J
4774N, 4774P, 4774P-450, 4774J



4753BRK 4753NB, 4753PB, 4753JB
4774NB, 4774PB, 4774JB



4725RK 4725Z



6749RK 6749, 6749-1000



6752RK 6752



8749RK 8749



	☑	⚖️ (g)	📦 (pce.)
3749SRK-1/2		120	1
3749SBRK-1/2		120	1
4749RK		130	1
4750RK		130	1
4750BRK	1/2"	130	1
4752RK		140	1
4753RK		130	1
4753BRK		130	1
4725RK		130	1
6749RK		580	1
6752RK	3/4"	600	1
8749RK	1"	800	1

New

HAND
MANUALES

Z-SERIES

TITANIUM
DE TITANIO

ACCESSORIES
ACCESORIOS

SCREWDRIVERS
DESTORNILLADORES

IMPACT
DE IMPACTO

SLEEVE-DRIVE

INDUSTRIAL
INDUSTRIALES

PROTECTOR
PROTECTORES

AUTOMOTIVE

CONSTRUCTION
CONSTRUCCION

RENEWAL KITS
JUEGOS DE PIEZAS REPUESTO

HAND
MANUALES

Z-SERIES

TITANIUM
DE TITANIO

ACCESSORIES
ACCESORIOS

SCREWDRIVERS
DESTORNILLADORES

IMPACT
DE IMPACTO

SLEEVE-DRIVE
INDUSTRIALES

INDUSTRIAL
INDUSTRIALES

PROTECTOR
PROTECTORES

AUTOMOTIVE

CONSTRUCTION
CONSTRUCCIÓN
JUEGOS DE PIEZAS/REPLUESTO

2755RK



3755RK



4755RK



6755RK



	□	⚖ (g)	📦 (pce.)
2755RK	1/4"	40	1
3755RK	3/8"	98	1
4755RK	1/2"	137	1
6755RK	3/4"	550	1

2768RK 2768N, 2768P, 2768J



3768RK 3768N, 3768P, 3768J

3768ZRK 3768Z



4768RK 4768N, 4768P, 4768J, 4781N-450

4768ZRK 4768Z



6768RK 6768



8768RK 8768



	□	⚖ (g)	📦 (pce.)
2768RK	1/4"	9	1
3768RK	3/8"	21	1
3768ZRK	3/8"	21	1
4768RK	1/2"	60	1
New 4768ZRK	1/2"	60	1
6768RK	3/4"	200	1
8768RK	1"	475	1

3112RK



	□	⊗ (pce.)
3112RK	3/8"	1
4112RK	1/2"	1
6112RK	3/4"	1

4112RK



6112RK



4100MRK 4100ARK

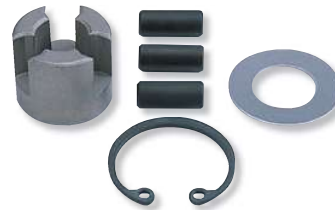

4100MRK (mm)	□	⊗ (pce.)
6	1/2"	1
7		1
8		1
9		1
10		1
10.5		1
11		1
12		1
14		1
16		1

4100ARK (inch)	□	⊗ (pce.)
1/4	1/2"	1
5/16		1
3/8		1
7/16		1
1/2		1
9/16		1
5/8		1

6100MRK (mm)	□	⊗ (pce.)
18	3/4"	1
20		1
22		1
24		1
27		1
28		1
29		1
30		1

162RK	⊗ (pce.)
5/16	1
3/8	1
1/2	1
10	1

6100MRK

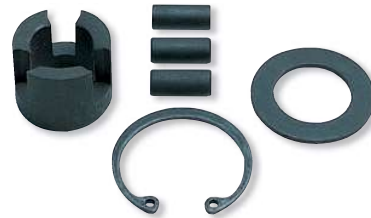

162RK



HAND
MANUALES

Z-SERIES

TITANIUM
DE TITANIO

ACCESSORIES
ACCESORIOS

SCREWDRIVERS
DESTORNILLADORES

IMPACT
DE IMPACTO

SLEEVE-DRIVE

INDUSTRIAL
INDUSTRIALES

PROTECTOR
PROTECTORES

AUTOMOTIVE

CONSTRUCTION
CONSTRUCCION

RENEWAL KITS
JUEGOS DE PIEZAS REPUESTO

HAND SOCKETS / Diameter of Bore

Standard Socket

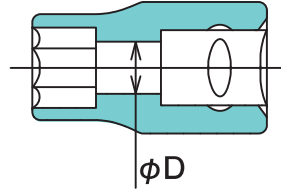

Deep Socket

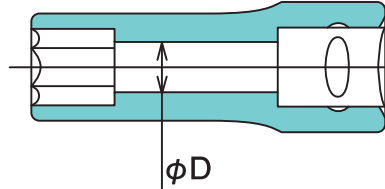

SOCKET		1/4" $\text{\textcircled{O}}$		3/8" $\text{\textcircled{O}}$		1/2" $\text{\textcircled{O}}$		3/4" $\text{\textcircled{O}}$		1" $\text{\textcircled{O}}$
		Standard	Deep	Standard	Deep	Standard	Deep	Standard	Deep	Standard
$\text{\textcircled{O}}$		2400M 2400A	2300M 2300A	3400M 3400A	3300M 3300A	4400M 4400A	4300M 4300A	6400M 6400A	6300M 6300A	8400M 8400A
$\text{\textcircled{O}}$		2405M 2405A	2305M 2305A	3405M 3405A	3305M 3305A	4405M 4405A	4305M 4305A	6405M 6405A	6305M 6305A	8405M 8405A
(mm)	(inch)	ϕD								
3	1/8	2.5	2.5							
4		3.5	3.5							
4.5		4	4							
5	3/16	4	4.5							
5.5	7/32	4.5	5	4.5	5					
6	1/4	5	5	5	5					
7	9/32	5.5	6	5.5	6					
8	5/16	6	7	6	7	6	7			
9	11/32	7	8	7	8	7	8			
10	3/8	8	9	8	9	8	9			
11	7/16	9	10	9	10	9	10			
12		10	11	10	11	10	11			
13	1/2	11	12	11	12	11	12			
14	9/16	12	13	12	13	12	13			
15	19/32			13	14	13	14			
16	5/8			14	15	14	15			
17	21/32			15	16	15	16	15	16	
18	11/16			15	17	15	17	15	17	
19	3/4			16	18	16	18	16	18	
20	25/32			17	19	17	19	17	19	
21	13/16			18	20	18	20	18	20	
22	7/8			19	21	19	21	19	21	
23				20	22	20	22	20	22	
24	15/16			21	23	21	23	21	23	
25						22	24	22	24	
26	1					23	25	23	25	
27	1- 1/16					23	26	23	26	23
28						24	27	24	27	24
29	1- 1/8					24	28	24	28	24
30	1- 3/16					25	29	25	29	25
31						26	30	26	30	26
32	1- 1/4					27	31	27	31	27
33	1- 5/16							28	32	28
34								29	33	29
35	1- 3/8							30	34	30
36								31	35	31
37	1- 7/16							31	36	31
38	1- 1/2							32	37	32
39								32	38	32
40	1- 9/16							33	39	33
41	1- 5/8							34	40	34
42								34	41	34
43	1-11/16							35	42	35
44	1- 3/4							36	43	36
45								36	44	36
46	1-13/16							37	45	37
47								38	46	38
48	1- 7/8							38	47	38
	1-15/16							39	48	39
50	2							40	49	40
	2- 1/16							40		

Standard Socket

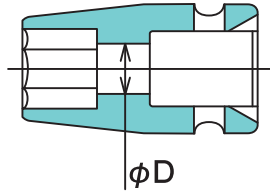

Deep Socket

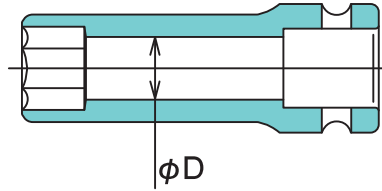

SOCKET		1/4" Ø		3/8" Ø		1/2" Ø		3/4" Ø		1" Ø	
		Standard	Standard	Deep	Standard	Deep	Standard	Deep	Standard	Deep	
Ø		12400M 12400A	13400M 13400A	13300M 13300A	14400M 14400A	14300M 14300A	16400M 16400A	16300M 16300A	18400M 18400A	18300M 18300A	
(mm)	(inch)	φD									
4		3									
4.5	3/16	3									
5		4									
5.5		4									
6	1/4	5	5	5							
7	9/32	5	5	6							
8	5/16	6	6	7	6	7					
9	11/32	7	7	8	7	8					
10	3/8	8	8	9	8	9					
11	7/16	9	9	10	9	10					
12		10	10	11	10	11					
13	1/2	11	11	12	11	12					
14	9/16	12	12	13	12	13					
15			13	14	13	14					
16	5/8		14	15	14	15					
17	11/16		14	16	14	16	14	16			
18			15	17	15	17	15	17			
19	3/4		16	18	16	18	16	18	16	18	
20			17	19	17	19	17	19	17	19	
21	13/16		18	20	18	20	18	20	18	20	
22	7/8		19	21	19	21	19	21	19	21	
23			20		20	22	20	22	20	22	
24	15/16				21	23	21	23	21	23	
25	1				22	24	22	24	22	24	
26					23	25	23	25	23	25	
27	1- 1/16				23	26	23	26	23	26	
28					24	27	24	27	24	27	
29	1- 1/8				25	28	25	28	25	28	
30	1- 3/16				26	29	26	29	26	29	
31					27	30	27	30	27	30	
32	1- 1/4				28	31	28	31	28	31	
33							29	32	29	32	
34	1- 5/16						30	33	30	33	
35	1- 3/8						31	34	31	34	
36							32	35	32	35	
37	1- 7/16						32	36	32	36	
38	1- 1/2						34	37	34	37	
40	1- 9/16						34	39	34	39	
41	1- 5/8						35	40	35	40	
42	1-11/16						35	41	35	41	
45	1- 3/4						35	44	35	44	
46	1-13/16						40	45	40	45	
47							40	46			
	1- 7/8						40	47			

Screw dimension	Hexagon Head Bolt			Hexagon Socket Head Cap Screws			TORX		TORXPLUS		Triple Square	LHSTIX	Ref.) Standard Tightning Torque (Nm)				
	Standard	Compact	High Strength	Standard	Button Head / Shoulder Head	Hexagon Socket Set Screws	T	E	IP	EP [EPL]	XZN	LH-S [LH-SS]	Grade 4.6	Grade 6.8	Grade 8.8	Grade 10.9	Grade 12.9
M2	4			1.5		0.9	T6/T8		6IP				0.12	0.24	0.32	0.45	0.54
M2.5	5			2		1.3	T8		8IP		M3		0.25	0.49	0.65	0.92	1.1
M3	5.5			2.5	2	1.5	T10	E4	8IP/10IP	4EP	M3		0.43	0.87	1.16	1.63	1.96
M3.5	(6)						T15		10IP/15IP				0.68	1.37	1.82	2.56	3.08
M4	7			3	2.5	2	T20/T25	E5	15IP/20IP	5EP	M4	LH4S	1.01	2.02	2.7	3.79	4.54
M5	8			4	3	2.5	T25/T27	E6	20IP/25IP /27IP	6EP [8EPL]	M5	LH5S	2.04	4.09	5.47	7.67	9.18
M6	10			5	4	3	T30	E8	27IP/30IP	8EP [10EPL]	M6	LH6S	3.47	6.97	9.27	13	15.6
M7	11						T40	E8	40IP	8EP [12EPL]			5.85	11.6	15.5	21.8	26.2
M8	13	(12)		6	5	4	T40/T45	E10	40IP/45IP	10EP [14EPL]	M8	LH8S	8.41	16.9	22.5	31.6	37.9
M10	16 (17)	(14)		8	6	5	T50	E12	45IP/50IP	12EP [16EPL]	M10	LH10S [LH8SS]	16.7	33.4	44.5	62.6	75.2
M12	18 (19)	(17)	21 (22)	10	8	6	T55	E14	55IP	14EP [20EPL]	M12	LH12S [LH10SS]	29.1	58.3	77.6	109	131
M14	21 (22)	(19)		12			T55/T60	E14/E18	55IP/60IP	18EP [24EPL]	M14	LH14S [LH12SS]	46.4	92.7	124	174	209
M16	24	(22)	27	14	10	8	T60/T70	E16/E20	60IP/70IP	20EP [26EPL]	M16	LH16S [LH14SS]	72.3	145	194	271	325
M18	27	(24)		(14)			T70/T80	E24	80IP	24EP [30EPL]	M18		100	199	266	373	447
M20	30 (32)	(27/29)	32	17	12	10	T80/T90	E24	90IP	24EP [32EPL]			141	282	376	529	635
M22	34 (32/35)	(30/32)	36	(17)			T90/T100	E28	100IP	24EP [36EPL]			192	384	511	720	865
M24	36 (38)	(32/35)	41	19		12	T100	E32	100IP	32EP [40EPL]			244	488	650	915	1100
M27	41	(36)	46	(19)				E32		32EP			358	713	951	1340	1610
M30	46	(41)	50	22				E36		36EP			484	971	1290	1820	2180
M33	50	(46)		(24)				E40		40EP			661	1320	1760	2470	2970
M36	55 (54)	(50)		27				E44		44EP			848	1690	2260	3180	3810
M39	60 (58)	(55)		(27)									1100	2190	2920	4110	4930
M42	65 (63)			32									1350	2710	3610	5080	6080
M45	70 (67)			(32)									1700	3400	4540	6370	7630
M48	75 (71)			36									2030	4060	5440	7620	9120
M52	80 (77)			(36)									2640	5290	7040	9880	11800
M56	85			41									3270	6560	8710	12300	14800
M60	90												4080	8180	10900	15300	18300
M64	95			46									4930	9890	13100	18500	22300
M68	(100)												5970	12000	16000	22500	27000

*Reference: Hexagon Head Bolt: ISO 4014-4018, 8676, 8768
 High Strength Hexagon Bolt: JIS B 1196
 Hexagon Socket Head Cap Screws: ISO 7380
 Hexagon Socket Button Head Screws: ISO 7380
 Hexagon Socket Set Screws: ISO 4026-4029
 TORX T/E: TORX Standard TMH series
 TORXPLUS IP/EP: TORXPLUS Standard CMH series
 Triple Square: DIN 2324/2325
 LHSTIX LH-S/SS: LH-S/SS Standard

* Standard Tightening Torque: Calculated based on Torque Coefficient (K): 0.2
 Axial Force (F): 60% of Proof Strength(σ)

TORX® / IORX^{plus} BITS

		S ₁ (mm)	S ₂ (mm)
T6	6IP	1.7	1.2
T7	7IP	2.0	1.4
T8	8IP	2.3	1.7
T9	9IP	2.5	1.8
T10	10IP	2.7	2.0
T15	15IP	3.3	2.3
T20	20IP	3.9	2.8
T25	25IP	4.5	3.2
T27	27IP	5.0	3.6
T30	30IP	5.6	4.0
T40	40IP	6.7	4.8
T45	45IP	7.9	5.6
T50	50IP	8.9	6.2
T55	55IP	11.3	8.0
T60	60IP	13.3	9.5
T70	70IP	15.6	11.1
T80	80IP	17.6	12.7
T90	90IP	20.0	14.2
T100	100IP	22.2	15.8

TORX® / IORX^{plus} SOCKETS

		S ₁ (mm)	S ₂ (mm)
E4	4EP	3.7	2.7
E5	5EP	4.6	3.3
E6	6EP	5.6	4.0
E7	7EP	6.1	4.3
E8	8EP	7.4	5.3
E10	10EP	9.3	6.8
E11	11EP	9.9	7.1
E12	12EP	11.0	7.9
E14	14EP	12.8	9.2
E16	16EP	14.6	10.5
E18	18EP	16.5	11.9
E20	20EP	18.3	13.2
E22	22EP	20.1	14.8
E24	24EP	22.0	15.7
E26	26EP	23.7	17.5
E28	28EP	25.5	18.3
E30	30EP	27.3	20.0
E32	32EP	29.0	21.3

PENTA-LOBE BITS

	S ₁ (mm)	S ₂ (mm)
8PR	2.2	2.0
9PR	2.4	2.2
10PR	2.6	2.4
15PR	3.1	2.8
20PR	3.6	3.3
25PR	4.1	3.8
27PR	4.7	4.3
30PR	5.2	4.8
40PR	6.3	5.7
45PR	7.4	6.7
50PR	8.4	7.6
55PR	10.6	9.7

LHSTIX® (LH-S) SOCKETS

	S ₁ (mm)	S ₂ (mm)
LH3S	3.8	4.7
LH4S	4.5	6.0
LH5S	5.6	7.5
LH6S	6.8	9.0
LH7S	7.9	10.5
LH8S	9.0	12.0
LH10S	11.3	15.0
LH12S	13.6	18.0
LH14S	15.8	21.0
LH16S	18.1	24.0

XZN BITS

	S ₁ (mm)	S ₂ (mm)
M4	3.6	3.1
M5	4.8	4.1
M6	6.1	5.1
M8	7.3	6.1
M10	9.7	8.1
M12	11.5	9.7
M14	13.3	11.2
M16	15.7	13.2
M18	16.9	14.2

Ribe CV BITS

	W (mm)	S ₁ (mm)	S ₂ (mm)
M5	1.2	5.0	3.8
M6	1.3	6.0	4.5
M7	1.4	7.0	5.0
M8	1.8	8.0	6.0
M9	2.0	9.0	7.1
M10	2.3	10.0	7.4
M12	2.6	12.0	9.0
M13	3.1	13.0	11.0
M14	3.2	14.0	10.4
M16	3.6	16.0	11.9

TORX® is a registered trademark of Acument Intellectual Properties, LLC.
 TORX® es una marca registrada de Acument Intellectual Properties, LLC.
 IORX^{plus} is a registered trademark of Acument Intellectual Properties, LLC.
 IORX^{plus} es una marca registrada de Acument Intellectual Properties, LLC.
 LHSTIX® is a registered trademark of OSG CORPORATION System Engineering Department.
 LHSTIX® es una marca registrada de OSG CORPORATION System Engineering Department.

